

SITUAČNÍ VÝKRES SADOVÝCH ÚPRAV

M 1:100

ČÁST 1

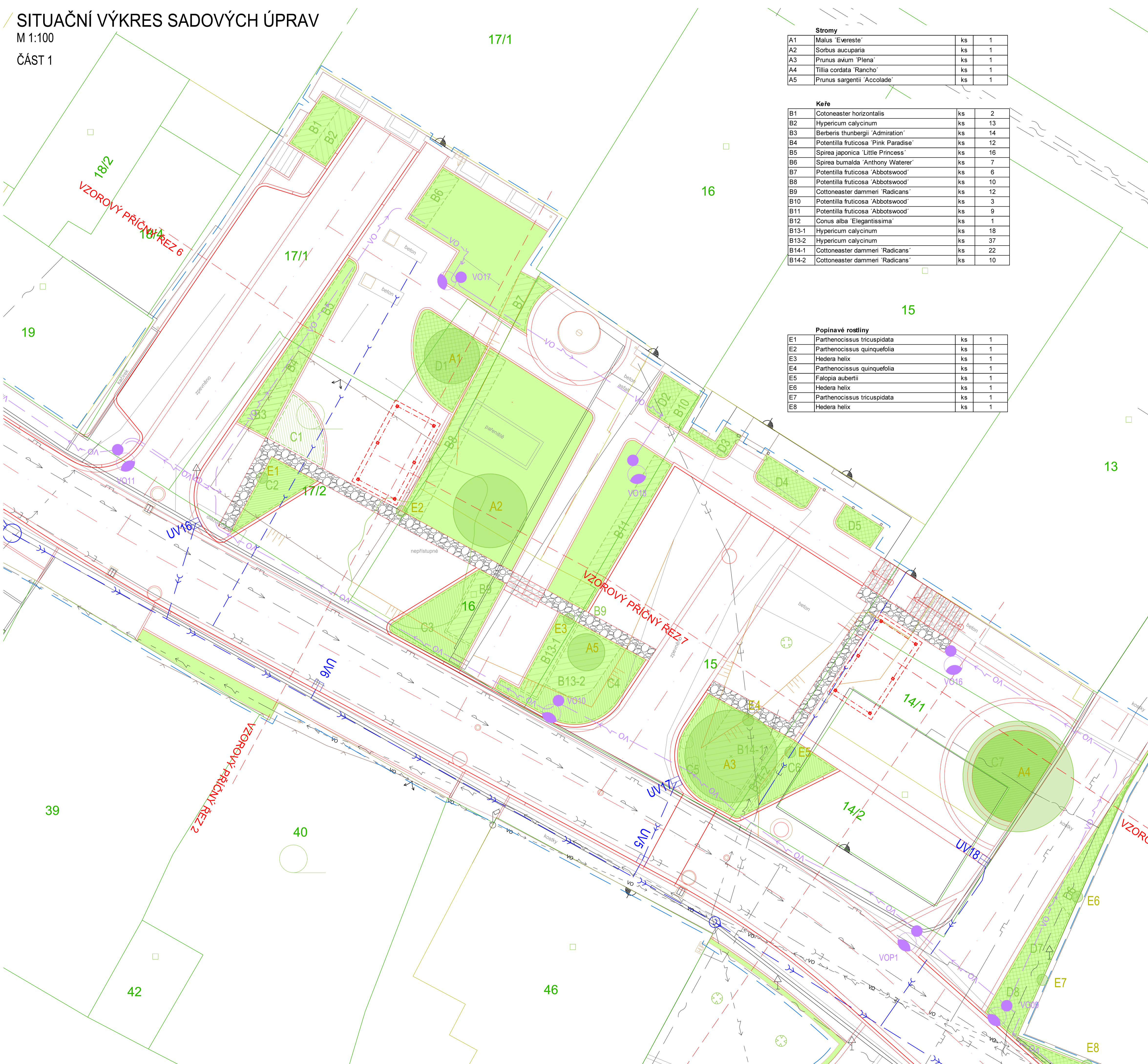

| Stromy | | | |
|--------|-----------------------------|----|---|
| A1 | Malus 'Evereste' | ks | 1 |
| A2 | Sorbus aucuparia | ks | 1 |
| A3 | Prunus avium 'Plena' | ks | 1 |
| A4 | Tillia cordata 'Rancho' | ks | 1 |
| A5 | Prunus sargentii 'Accolade' | ks | 1 |

| Keře | | | |
|-------|--------------------------------------|----|----|
| B1 | Cotoneaster horizontalis | ks | 2 |
| B2 | Hypericum calycinum | ks | 13 |
| B3 | Berberis thunbergii 'Admiration' | ks | 14 |
| B4 | Potentilla fruticosa 'Pink Paradise' | ks | 12 |
| B5 | Spirea japonica 'Little Princess' | ks | 16 |
| B6 | Spirea bumalda 'Anthony Waterer' | ks | 7 |
| B7 | Potentilla fruticosa 'Abbotswood' | ks | 6 |
| B8 | Potentilla fruticosa 'Abbotswood' | ks | 10 |
| B9 | Cotoneaster dammeri 'Radicans' | ks | 12 |
| B10 | Potentilla fruticosa 'Abbotswood' | ks | 3 |
| B11 | Potentilla fruticosa 'Abbotswood' | ks | 9 |
| B12 | Conus alba 'Elegantissima' | ks | 1 |
| B13-1 | Hypericum calycinum | ks | 18 |
| B13-2 | Hypericum calycinum | ks | 37 |
| B14-1 | Cotoneaster dammeri 'Radicans' | ks | 22 |
| B14-2 | Cotoneaster dammeri 'Radicans' | ks | 10 |

| Popínivé rostliny | | | |
|-------------------|-----------------------------|----|---|
| E1 | Parthenocissus tricuspidata | ks | 1 |
| E2 | Parthenocissus quinquefolia | ks | 1 |
| E3 | Hedera helix | ks | 1 |
| E4 | Parthenocissus quinquefolia | ks | 1 |
| E5 | Falopia aubertii | ks | 1 |
| E6 | Hedera helix | ks | 1 |
| E7 | Parthenocissus tricuspidata | ks | 1 |
| E8 | Hedera helix | ks | 1 |

| | | | |
|----------|---|----|-----|
| C1 - C12 | Deschampsia caespitosa 'Schottland' | ks | 21 |
| | Filipendula vulgaris 'Plena' | ks | 62 |
| | Gypsophila paniculata 'Festival White' | ks | 21 |
| | Molinia caerulea 'Edit Dudsuz' | ks | 82 |
| | Aster amellus 'Veichen'ingen' | ks | 124 |
| | Bupthalmum salicifolium 'Alpengold' | ks | 82 |
| | Achillea millefolium 'Paprika' | ks | 82 |
| | Campanula persicifolia 'Grandiflora Coerulea' | ks | 82 |
| | Deschampsia caespitosa 'Palava' | ks | 82 |
| | Euphorbia polychroma 'Bonfire' | ks | 82 |
| | Geranium pratense 'Midnight Reiter' | ks | 82 |
| | Inula ensifolia 'Compacta' | ks | 82 |
| | Iris x barbata - media | ks | 62 |
| | Origanum vulgare 'Aureum' | ks | 62 |
| | Salvia nemorosa 'Schwellenburg' | ks | 103 |
| | Salvia pratensis 'Swan Lake' | ks | 62 |
| | Sedum 'Black Jack' | ks | 82 |
| | Veronica teucrium 'Kapitan' | ks | 82 |
| | Anemone sylvestris 'Flore Pleno' | ks | 124 |
| | Dianthus deltoides 'Brilliant' | ks | 103 |
| | Geranium sanguineum 'Striatum' | ks | 124 |
| | Prunella grandiflora 'Rubra' | ks | 124 |
| | Thymus praecox 'Atropurpurea' | ks | 124 |
| | Catananche caerulea | ks | 41 |
| | Verbascum nigrum 'Album' | ks | 21 |
| | Verbascum phoeniceum 'Southern Cham' | ks | 62 |
| | Allium roseum | ks | 920 |
| | Allium neapolitanum | ks | 690 |
| | Iris reticulata 'Purple Gem' | ks | 460 |
| | Iris danfordiae | ks | 460 |
| | Muscari botryoides 'Superstar' | ks | 690 |
| | Gladiolus communis | ks | 460 |
| | Tulipa praestans 'Unicum' | ks | 920 |
| | Tulipa tarda | ks | 920 |

| Trvalkový záhon jednodruhový | | | |
|------------------------------|---------------------------------|----|----|
| D1 | Nepetta faassonii 'Walkers Low' | ks | 36 |
| D2 | Geranium macrorrhizum | ks | 10 |
| D3 | Sedum telephium | ks | 5 |
| D4 | Veronica spicata | ks | 16 |
| D5 | Sedum telephium | ks | 8 |
| D6 | Geranium macrorrhizum | ks | 23 |
| D7 | Sedum telephium | ks | 22 |
| D8 | Nepetta faassonii 'Walkers Low' | ks | 18 |

LEGENDA SADOVÝCH ÚPRAV:

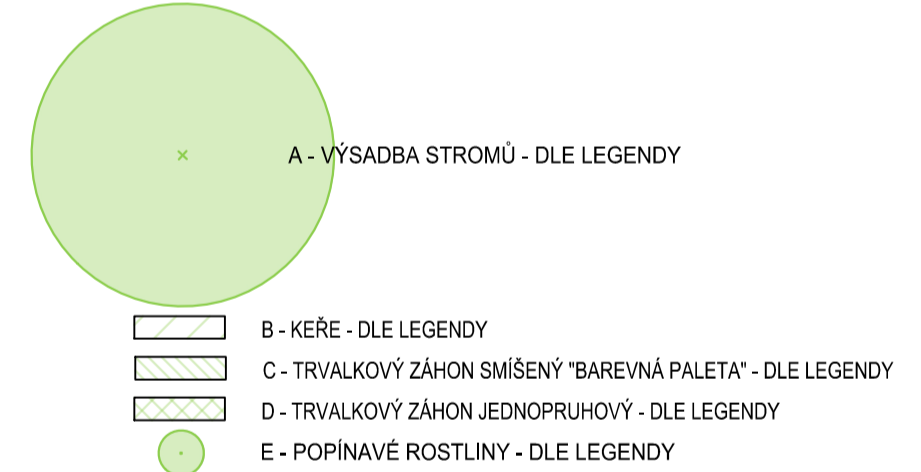

| | | | |
|---|--|-------------------------------------|----------------------|
| Souřadnicový systém S-JTSK | | Výškový systém B.p.v. | |
| Vedoucí projektant ING. LUBOMÍR KONVIČNÝ | Zodpovědný projektant ING. LUBOMÍR KONVIČNÝ | Vypracoval ING. LUBOMÍR KONVIČNÝ | |
| INVESTOR: Město Rýmařov, IČ: 00296317, DIČ: CZ 00296317, náměstí Míru 1, 795 01 Rýmařov | ÚČEL: Projektová dokumentace pro stavební povolení | AKCE: Oprava MK Husova, Rýmařov | |
| ČÁST: C situační výkresy | OBJEKT: PRÍLOHA: SITUACE SADOVÝCH ÚPRAV ČÁST 1 | DATUM: 07/2021 | FORMÁT: 4x2A4 |
| | | ÚČEL: DSP | ČÍSLO PŘÍLOHY: 1911 |
| | | MĚŘÍTKO: 1:100 | ČÍSLO VÝKRESU: C.4.1 |